



French language diplomas

B1 | B2 | C1 | C2 | C3
PROGRAM 2022-2024

Anglais

SELFEE-Sorbonne Université
Service des Examens de Langue Française
réservés aux Étudiants Étrangers

Contents

Introduction	1
Validation of FLE certifications	2
Our French language certifications	3
French literature and civilization programs C1, C2, C3.....	10
Exam registration	13
Partnerships	17
Appendix	18

The Sorbonne French Foreign Language Exam Center

A word from the director

The Faculty of Arts and Humanities, within Sorbonne University, issues diplomas corresponding to five levels of knowledge of French language and culture to foreigners who wish to validate their mastery of 'French as a foreign language' (FLE). In accordance with European language directives (CEFR), these specific certifications were established in 1959 by the French Ministry of National Education and Foreign Affairs.es.

Placed under the authority of Sorbonne University, the Service des Examens de Langue Française réservés aux Étudiants Étrangers (SELFEE Sorbonne University) is in charge of their organization. These diplomas facilitate access to educational programs and degrees in French universities, especially in the humanities, since they include university-style tests from C1 onwards. They are issued under the signatures of the Rector Chancellor of the Universities of Paris, the President of Sorbonne University and the Director of SELFEE.

Each year, more than 5,000 international candidates from many different nationalities take the Sorbonne University exams, contributing to rich international and cultural exchanges between students and countries. SELFEE works closely with the Faculty of Arts and Humanities to help with their integration. Its certifications are, moreover, in many countries, the guarantee of recognized mastery of French language and culture, which brings with it many further positive consequences for professional life.

Since 2021, SELFEE has been offering, in addition to its own certifications, the DELF and DALF of France Education International. Some exams can now be taken at a distance, outside of the centers that have been set up around the world. An intense collaboration with the SIAL (Service Interuniversitaire d'Apprentissage des Langues) of the Sorbonne is finally allowing the implementation of distance learning courses that will facilitate the preparation of the various certifications, thus helping the French language to remain or become an asset in more and more countries. Directeur : M. Jacques DÜRRENMATT



THE SELFEE-SORBONNE UNIVERSITÉ IN NUMBERS

5 000

5000 registered students

49

nationalities

13

Partner centers

5

Certifications offered

87%

Participant success rate

Skills and validations of diplomas

Level	Diploma	Public	User
Language certifications, introduction to literature			
B1	Practical certificate of French language	General public	threshold I
B2	Certificat pratique de langue française "compréhension et expression"	General public	Independant
Certifications in French language, literature and civilization			
C1	Practical certificate of French language	General public	Experienced
C2	Diploma of French language and literature	General public	Mastery
C3 [†]	Advanced Diploma of French Studies	General public	Operational and intercultural skills

* CEFR: Common European Framework of Reference for Languages

† Specific certification at Sorbonne University





**OUR FRENCH AS A
FOREIGN LANGUAGE CERTIFICATIONS**

B1 INTERMEDIATE CERTIFICATE OF FRENCH LANGUAGE

Level: B1 threshold

Target audience: This language certification is intended for any member of the international public who is beginning to progress in learning French.

Benefits: allows you to apply for French nationality.

Description of the test

Duration of the test: 2 hours 20 minutes

I.	Grammaire et orthographe 20 points	Spelling and grammar exercises	30 minutes
II.	Compréhension écrite 20 points	Comprehension questions based on a simple literary excerpt of approximately 500 words.	30 minutes
III.	Written production 20 points	Written test of 200 words.	45 minutes
IV.	Oral comprehension 20 points	Comprehension (15 points) Comprehension questions about an audio sample corresponding to a cultural or literary text. The audio document lasts about 4 minutes. (Two listening sessions). Actes de paroles (5 points) Questions de compréhension sur les actes de langage entendus dans un document sonore correspondant à un court dialogue sur un thème de la vie quotidienne.	15 minutes approximately
V.	Oral presentation 20 points	An oral presentation based on a text of approximately 200 words or an iconographic document, followed by a short interview with the jury.	20 minutes Preparation time: 10 minutes Exposition time: 10 minutes

Validation is awarded at 50/100. A mark of less than 4/20 in any test, written or oral, is eliminatory regardless of the average mark.

B2 PRACTICAL CERTIFICATE OF FRENCH LANGUAGE

Level: B2 Independent

Target audience: This language certification is intended for any member of the international public who is beginning to progress in learning French.

Benefits: allows to register to undergraduate level

Description of the test

Duration of the test: 3 hours 20 minutes

<p>I. Grammar and spelling 20 points</p>	<p>Spelling and grammar exercises</p>	
<p>II. Written comprehension 20 points</p>	<p>Comprehension questions about a text in the humanities and social sciences, or an excerpt from a literary work - all genres and all periods possible - of approximately 1000 words in length.</p>	
<p>III. Written task 20 points</p>	<p>Based on the reading comprehension text, students will be asked to write a text of approximately 300 words. Two topics to choose from will be offered:</p> <ul style="list-style-type: none"> - Imaginative topic: write a story, letter or conversation. • - Argumentative topic: contribute to a debate, express a judgment, defend a point of view, etc. 	<p>2 hours 30 minutes</p>
<p>IV. Oral comprehension 20 points</p>	<p>Comprehension questions based on an audio or video document in the humanities and social sciences or arts (including literature) lasting approximately 10 minutes. (two listening sessions).</p>	<p>Approximately 20 minutes</p>
<p>V. Oral production 20 points</p>	<p>Commentary on a document or set of documents of approximately 500 words in length, or a presentation based on material in the document..</p>	<p>30 minutes Preparation time: 15 minutes Exposition time: 15 minutes</p>

Validation is awarded at 50/100. A mark of less than 5/20 in any test, written or oral, is eliminatory regardless of the average mark.

C1 PRACTICAL CERTIFICATE OF FRENCH LANGUAGE

Level: C1 - Experienced

Target audience: this language certification is intended for any member of the international public wishing to validate strong language skills, academic know-how adapted to the requirements of the French system, and good knowledge of the French language.

Benefits: Successful participants will be exempted from any language test required for registration at Sorbonne University.

Description of the test: literature or FOU "Humanities and Social Sciences."

Duration of the test: 3 hours 30 minutes

I. Written production 50 points	Literary stream Commentary of approximately 300 words in length based on an extract of the literary program. FOU stream (French for university purposes) stream. Synthèse d'environ 250 mots à partir de courts documents appartenant à différents domaines des sciences humaines. <i>Une partie de la note validera la maîtrise de la grammaire et de l'orthographe.</i>	2 hours
II. Oral comprehension 25 points	Comprehension questions based on an audio or video document in the humanities and social sciences or arts (including literature) lasting approximately 10 minutes. (two listening sessions).	Approximately 30 minutes
III. Oral production 25 points	Commentary on a document or set of documents of approximately 500 words in length, or a presentation based on material in the document.	1 hour Preparation time: 45 minutes Exposition time: 15 minutes

Validation is awarded at 50/100. A mark of less than 10/50 or 5/25 in any test, written or oral, is eliminatory regardless of the average mark.

C2 PRACTICAL CERTIFICATE OF FRENCH LANGUAGE

Level: C2 Mastery - Language proficiency and academic skills

Target audience: this diploma is intended for any member of the international public wishing to prove that they can follow a higher education course in the French system. It attests to language skills acquired in a professional environment.

Pre-requisites: Participants must already hold the Practical Certificate of French Language C1, or DALF C1.

Benefits: recommended for enrolling in a university PhD program.

Description of test: literature or FOU "Humanities and Social Sciences."

Duration of the tests: 5 hours

I. Translation 20 points	Translation into the language chosen at the time of registration. - Version (10 points): translation of a French literary or cultural text of approximately 150 words into the chosen language. - Theme (10 points): translation of five sentences from the chosen language into French..	1 hour
II. Written production 40 points	Literary stream <ul style="list-style-type: none">• Writing of a short text based on an extract from the literature program (1/3).• Commentary on the extract in question of at least 300 words (2/3). FOU stream <ul style="list-style-type: none">• Summary/review of a humanities text (1/3).• Argumentative commentary of a part or a questions of the document in question in 300 words minimum (2/3)	2 hours30 minutes
III. Oral production and comprehension 40 points	<ul style="list-style-type: none">• Comprehension questions on an audio or video document in the humanities or social sciences of approximately 10 minutes in length. (two listenings). (1/3)• Presentation of the document and presentation in line with the questions developed in the document (2/3).	1 hours 30 minutes Preparation time: 1 hour Exposition time: 30 minutes

L'admission est prononcée à 50/100. Une note inférieure à 4 sur 20 à l'épreuve de traduction et 8 sur 40 aux deux autres est éliminatoire indépendamment de la note moyenne.

C3 HIGHER DIPLOMA OF FRENCH STUDIES

Level: Level: C3 - Operational and intercultural skills.

Target audience: this diploma is intended for any member of the international public wishing to prove that they can follow a higher education course in the French system. It attests to language skills acquired in a professional environment.

Pre-requisites: Participants must hold the Practical certificate of French language C2 and have a French baccalaureate or a title accepted as equivalent (an exemption may be granted)

Benefits: This degree is offered by Sorbonne University. It validates an excellent command of the language and the technical and methodological skills required in a literary curriculum.

Favors access to jobs in culture, tourism, teaching, translation and interpretation.

Description of the tests

Duration of the written eligibility tests: 9 hours 30 minutes

I. Translation 20 points	Translation into the language chosen at the time of registration. Version /10: translation of a French text of a literary or cultural nature of approximately 150 words into the chosen language. Theme /10: translation of a literary or cultural text of approximately 150 words in the chosen language into French. The candidate must demonstrate a strong command of the French language. The lexicon and syntax must conform to the rules of the language but also reflect the spirit and subtleties of the texts. Spelling will be taken into account for 6 points for each test.	3 hours
II. Résumé 10 points	Summary of a humanities, social sciences, cultural or literary text to a quarter of its length.	2 hours 30 minutes
III. Written production 20 points	Essay or commentary: Subject of literary reflection on the works in the programs. Grading will take into account: - the accuracy and fluency of the language; - the organization of the page (plan, reasoning, structure) - adequate use of examples.	4 hours

Oral admission test

Total duration: 1 hour30 minutes

IV. Listening comprehension and production

30 points

History of French civilization and literary explanation

The candidate is asked to answer one or more questions about historical facts and civilization related to one of the texts on the program, and then to explain an excerpt from the same text of approximately 800 words. The test is accompanied by an interview.

The 30-point score is broken down as follows

I. French civilization questions (8 points)

The treatment of the history and civilization question does not require any specialized knowledge. It should shed light on the conditions of the creation and reception of the text about which the question is asked.

II. Literary explanation (10 points)

The explanation of the text takes the form of an analysis of the proposed excerpt in order to reveal its major thematic and formal features. The test is accompanied by an interview.

III. Linguistic competence (12 points)

Preparation time :

1 hour

Presentation time :

30 minutes

A score of 0 in any test, written or oral, will result in the candidate's elimination. Eligibility is given at 25/50, admission at 40/80. Eligibility is acquired for two consecutive sessions in the same calendar year. Total duration of the written and oral tests : 11 hours.



Literature program
C1, C2 et C3

C1

CERTIFICAT PRATIQUE DE LANGUE FRANÇAISE Programme de littérature

Diderot
Histoire de
Mme de La Pommeraye



**DENIS DIDEROT, *Histoire de Mme de La Pommeraye*
précédé de *Sur les femmes***

Édition d'Yvon Belaval, collection « Folio classique », n° 6556, Paris, 2018.

Albert Cohen
Ô vous,
frères humains



ALBERT COHEN, *Ô vous, frères humains*

Éditions Gallimard, collection « Folio », n° 1915, première parution en 1972, Paris, 1988.

C2

CERTIFICAT PRATIQUE DE LANGUE FRANÇAISE Programme de littérature



LAURENT MAUVIGNIER, *CONTINUER*

Les Éditions de Minuit, 2016.

Version numérique : ISBN PDF : 9782707344823 - ePub : 9782707344816



JEAN RACINE, *ANDROMAQUE*

Belin, collection « Classico Lycée », n° 22, Gallimard, Paris, nouvelle édition 2017.
Notes, présentation et dossier par Aurélie Gellé.

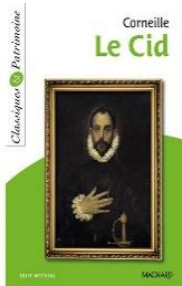

XVIIe siècle : PIERRE CORNEILLE, *Le Cid*

Éditions Magnard, collection « Classiques & patrimoine », Paris 2011.



XVIIIe siècle : JEAN-JACQUES ROUSSEAU, *Les Confessions (tomes I à VI)*

Éditions Flammarion, collection « GF », n° 1019, Paris, 2012.

Notes, présentation et notes par Alain Grosrichard.

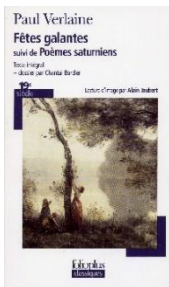

XIXe siècle : PAUL VERLAINE, *Fêtes galantes*

Éditions Gallimard, collection « Folio plus classiques », n° 38, Paris, 2005.

Dossier par Chantal Bordier.



XXe siècle : ANNIE ERNAUX, *La Place*

Éditions Gallimard, collection « Folio plus classiques », n° 61, Paris 2006.

Oral exam

Questions d'histoire et explication littéraire

- La France de Richelieu
- Le règne de Louis XV
- Le Second-Empire
- Les Trente Glorieuses (1945-1975)



REGISTRATION

Who can register for FLE exams of the Sorbonne University Faculty of Arts and Humanities?

These exams are intended for an international audience of adults or young adults, students or not. A candidate may take several exams during the same calendar year

Comment s'inscrire aux examens FLE ?

You can consult all the information necessary for your registration and download the required files at the following page: <http://lettres.sorbonne-universite.fr/selfee>

3 means of communication are at your disposal

On site	En Sorbonne, Bureau F 672 - Cour Cujas ou St. Jacques Escalier H - 1 ^{er} étage sur la courside Tél. : + 33 1 40 46 32 20 / 32 22 Du lundi au vendredi de 9h30 - 12h30 et de 14h00 - 17h00 Fermé le mercredi
By mail	Faculté des Lettres de Sorbonne Université SELFEE-Sorbonne Université 1 rue Victor Cousin 75230 Paris Cedex 05
By email	lettres-selfee@sorbonne-universite.fr

How do I pay the registration fee?

- **By card** online or on site,
- **By cheque** from a French bank on site or by mail,
- **By transfer**

As soon as we receive your complete file (registration form and proof of payment), you will receive a notice to attend the exam

Registration for the exams is final. No refunds will be given unless the SELFEE-Sorbonne University is forced to suspend the exam.

How to prepare for the FLE exams??

Sorbonne

Faculté des Lettres / SIAL-FLE
Centre de Clignancourt
2, rue Francis-de-Croisset, 75018 Paris
Tél. : 01 53 09 57 41
Courriel : lettres-sial-fle@sorbonne-universite.fr

By yourself

By consulting the records of subjects that are available free of charge on our website, on the page " Annales corrigées " .

France and abroad

With our partner centers.





Our partner centers

Partnerships

Partnerships with accredited centers play an important role in the development of our national and international exchanges.



Abu Dhabi

<https://www.sorbonne.ae/>



Egypte

<https://www.ifegypte.com/alexandrie/>



Alliance Française
Malte-Méditerranée

Malte

<https://alliancefrmalta.com/>



Espagne

<https://www.lecole.es/>



Cercle Franco-hellénique

France, Toulouse

<http://cercle.toulouse.free.fr/>



Montpellier
Education
蒙彼利埃教育

Chine

École Internationale de Montpellier de
Chengdu



France, Paris

<http://sial.paris-sorbonne.fr/francais-fle/>



Grèce

<https://www.ifg.gr/fr/examens/diplomes/>



Suisse

<http://afge.ch/>



Pologne

<http://www.irom.uw.edu.pl/>



Portugal

<https://prof-online.pt/>



Maroc

<https://www.universalsup.ma/>

To obtain more information (to take the exams in one of our partner centers, or to become a Sorbonne University FLE exam center) you can contact us or consult our website on the page "Approved partner centers"



Appendix

Plan de la Faculté des Lettres de Sorbonne Université

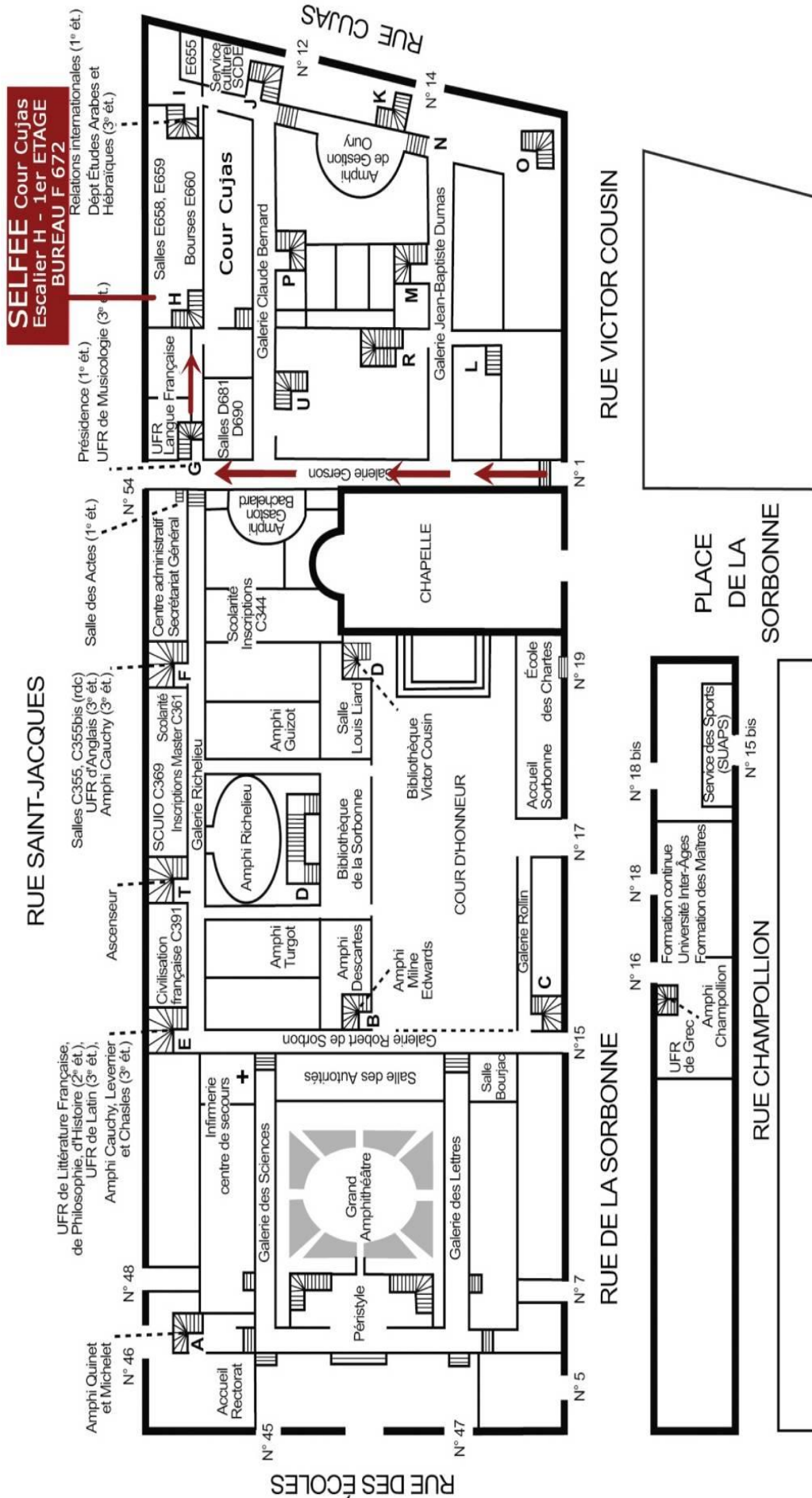

PLACE DE LA SORBONNE

RUE CHAMPOLLION

BOULEVARD SAINT-MICHEL



**Faculté des Lettres
de Sorbonne Université**

1, rue Victor Cousin
75230 Paris CEDEX

Tél. 01 40 46 22 11

www.lettres.sorbonne-universite.fr